

使用说明书

感谢您购买我们的产品!
www.jetbeamlight.com

产品特性

- 1、造型精致小巧，方便随身携带，多用于日常徒步、露营、维修、应急等多种照明用途；
- 2、恒流模拟调光，输出亮度稳定；
- 3、使用Cree XPG3 S4 灯珠，最高输出达650流明；
- 4、使用晶透技术，结合全新数字化光学系统设计光杯，射程高达129米；
- 5、采用高效率数字化恒流电路，续航时间高达100小时；
- 6、新一代IC数字电路设计，LED与电池双重智能保护，最大程度延长LED和电池使用寿命，使用更安全；
- 7、IPX-8防水标准（水下2米）

产品参数

LED: Cree XPG3 S4

最大输出: 650流明

反光杯: 金属反光杯

筒身材质: 航天铝合金

筒身处理: 军规三级硬质氧化表面耐磨处理

使用电池: 1*AA/1*14500

开关: 侧按开关

长度: 97.7mm

头部直径: 19.1mm

尾部直径: 19mm

重量: 35.4克（不含电池）

选用电池

电池类型	尺寸规格	标称电压	是否可用
镍氢电池	AA	1.2V	推荐
碱性电池	AA	1.5V	可用
一次性锂电池	AA	1.5V	可用
可充锂离子电池	14500	3.7V	可用

亮度和时间

FL1 STANDARD	高亮 1*14500	高亮 1*AA	中亮 1*AA	低亮 1*AA
	650流明	190流明	46流明	4流明
	0.5小时	1.1小时	9小时	100小时
	129米			
	4100坎德拉			
	1米（防跌落高度）			
	IPX-8，水下2米			



注:

- 1.以上数据按照国际手电筒测量标准ANSI/NEMA FL1所述之测量方法，使用1节1.5V AA镍氢充电电池在实验室内测量所得，不同电池或使用环境可能会对以上数据产生影响



警告

1. 请将电池按照正负极灯头方向放入，反装电池电筒将不能工作。
2. 若电筒放置在背包内运输或者长时间储存请把电筒内的电池取下防止错误开启或电池漏液。
3. 不能将光线直接照射眼睛，以免对眼睛造成伤害。

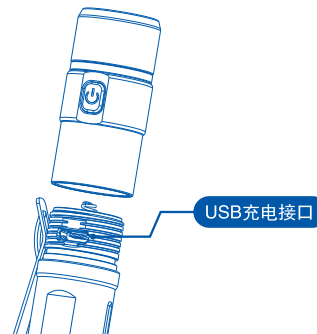

电筒操作

装入电池

请按下图所示，电池正极朝向电筒头，装入1节AA电池或者1节14500锂电池。

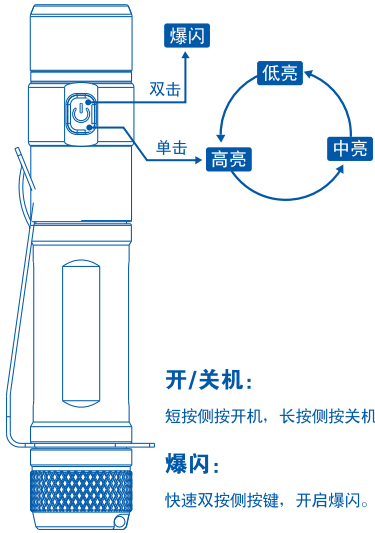
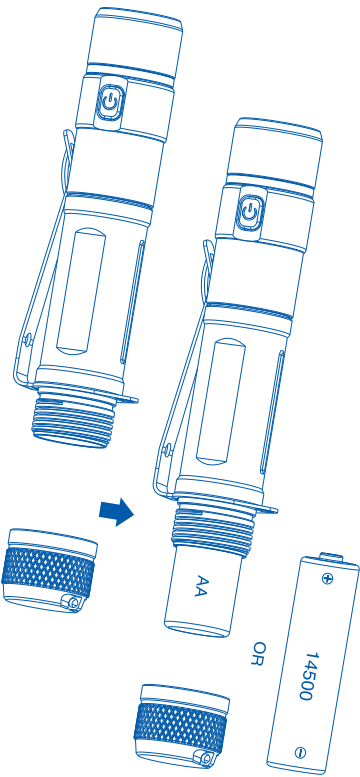

开/关机:

短按侧按开机，长按侧按关机。

爆闪:

快速双按侧按键，开启爆闪。

改变亮度:

单击侧按开关,依次（高亮—中亮—低亮）循环换档，有记忆。

充电显示:

AA镍氢电池：充电中，红绿色LED都亮；

充电饱和，只亮红色LED。

14500 锂离子电池：充电中，红色LED亮；

充电饱和，蓝色LED亮。

记忆功能

照明档带记忆功能,再次开启电筒时自动进入最后一次使用的档位。

更换电池

当电池电量不足,电筒甚至会出现亮度变暗或无法调光的情况.此时,应更换电池。

保养电筒

请每半年使用软布清洁电筒的螺牙，并使用硅润滑油润滑螺牙。

保固

JETBEAM® 产品拥有售后保固服务,在购买本产品的15天内,如果有任何质量问题均可向经销商要求免费更换.在购买本产品的24个月内享受免费保固服务.在超过24个月免费保固期后,本产品享有终身有限度保固服务,如需要更换重要部件则需收取成本费用。

本保固规则不适用于以下情况:

1. 人为破坏,拆解,改装本产品。
2. 错误操作导致产品损坏(如装反电池等)。
3. 电池漏液导致产品损坏。

如需协助,JETBEAM® 敬请消费者首先联系购买产品的经销商或零售商,以获得最迅速的售后服务或发邮件到 info@jetbeamlight.com。

备注: 产品数据如有更新,敬请以JETBEAM官方网站为准。

★ 仅限国内区域,跨区销售将不予保修。

深圳市杰特明电子科技有限公司

咨询热线: +86-0755-28077748

销售邮箱: info@jetbeamlight.com

网 址: www.jetbeamlight.com

公司地址: 广东省深圳市龙华新区大浪南路墩背工业区一栋三楼

邮 编: 518109

RoHS FC CE

Features

1. With compact design and mini size, it 's easy to carry with, and specially designed for hiking, camping, emergency, etc.
2. With constant-current mode changing and stable output.
3. With CREE XPG3 S4 and max output of 650 lumens.
4. Combining new crystal transparent technology and new digital optical system design, it has beam distance up to 129 meters.
5. Adopting high-efficiency digital constant current circuit, it has run time up to 100 hours.
6. With new circuit design of double protection of LED and battery, so as to maximize the life of LED and battery, as well as ensure safer use.
7. IPX-8 waterproof (2 meters under the water)

Specification

LED: Cree XPG3 S4

Max output: 650 lumens

Reflector: metallic reflector

Material of body: Aero grade aluminum alloy with hard anodized finish.

Battery: 1*AA/1*14500

Switch: side switch

Dimensions:

Length: 97.7mm

Diameter of head: 19.1mm

Diameter of tail: 19mm

Weight: 35.4 grams (without battery)

Recommended batteries

Type	Dimensions	Nominal Voltage	Usability
Ni-MH Battery	AA	1.2V	Recommended
Alkaline Battery	AA	1.5V	Usable
Non-rechargeable Battery (Lithium)	AA	1.5V	Usable
Rechargeable Battery (L-ion)	14500	3.7V	Usable

Output & Runtime

FL1 STANDARD	High 1*14500	High 1*AA	Mid 1*AA	Low 1*AA
	650LUMENS	190LUMENS	46LUMENS	4LUMENS
	0.5h	1.1h	9h	100h
	129 meters (Beam Distance)			
	4100cd (Max Intensity)			
	1 meter (Impact Resistant)			
	IPX-8(2 meter under the water)			



Note:

Stated data has been measured according to the international flashlight testing standards ANSI/NEMA FL1 by using one 1.5V AA in the laboratory. The data may vary due to different batteries and different environment conditions.

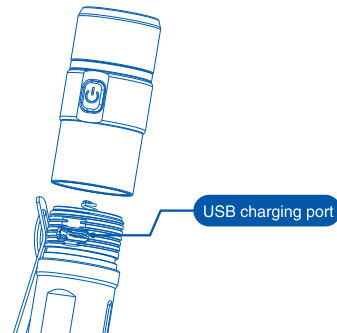

Operation of flashlight:

Insert the battery

Insert 1* AA Ni-MH battery ro 1*14500 rechargeable battery.

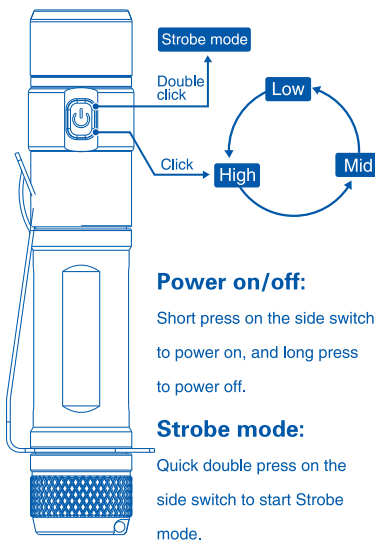
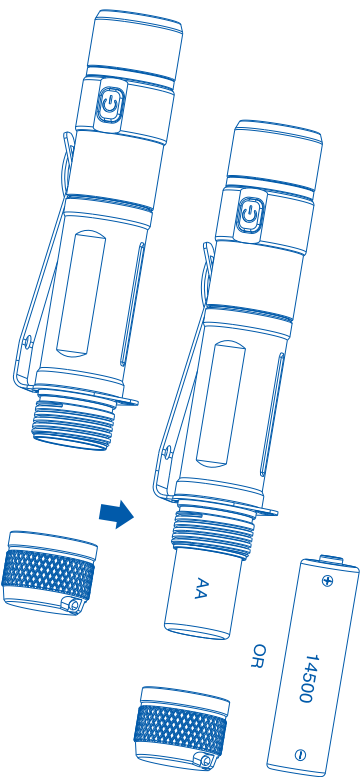

Power on/off:

Short press on the side switch to power on, and long press to power off.

Strobe mode:

Quick double press on the side switch to start Strobe mode.

Mode changing:

Press on the side switch to enter the modes in turn as High > Mid > Low.

The mode changing has memory.

Charging indicator:

For AA Ni-MH battery: both the red and green light turn on during charging time, and the green light will go off when fully charged.

For 14500 lithium-ion battery: the red light turns on during charging time; and the blue light turns on after fully charged.

Memory function: The mode changing has memory that when you reboot your flashlight after the first use, it will automatically turn into the mode which is set before powered off.

Storage and maintenance

1. Remove the batteries if light will be stored or unused for an extended time period.
2. Store the flashlight away from fire and high humidity environments.
3. Clean the body with a soft cloth; lubricate threads and O-ring with silicon grease semi-annually.

Warranty

1. Within 15 days of purchase, free replacement is provided by seller.
2. JetBeam offers a 24 month (2 year) free warranty service from date of purchase. Buyer will only be responsible for shipping costs of item. After 24 months, buyer is responsible for replacement parts as well as shipping costs.

Unwarrantable

- 1.Damage, destruction, disassembly and unauthorized intentional modifications.
- 2.Destruction caused by wrong operation (such as reversing batteries).
- 3.Damage due to improper storage or battery leakage.

Service

- 1.Contact your retailer, or email us info@jetbeam-light.com, call us +86-755-28077748,
- 2.Any update information will be displayed on www.jetbeamlight.com, and which we reserve the right to change information.

For more information, please follow us on facebook: JETBeam.

JETBeam Electronic Technology Co., Ltd

E-mail: info@jetbeamlight.com

Tel: +86-0755-28077748

Fax: +86-0755-28175738

Website: www.jetbeamlight.com

ADD: 3/F, Building 1, Dunbei Industrial Area, Dalang South Road,

Longhua New District, Shenzhen, 518109, China

RoHS FC CE